

Arcana Strum – Advanced Features

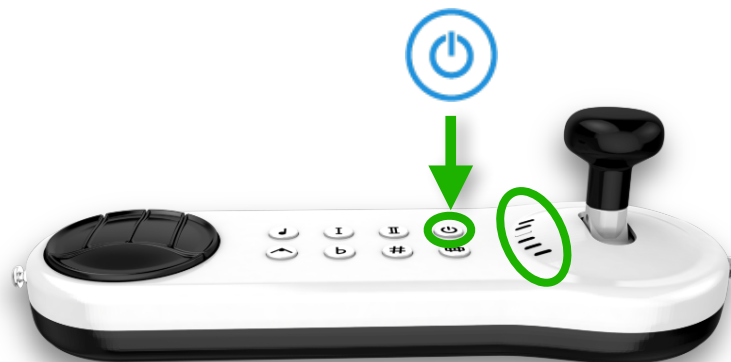

Checking Battery Status

Hold down the Power button for 2 seconds to display the battery level. When all 6 Strum LEDs are on, this indicates that the battery is fully charged.



Disable Auto-Off

When not connected to USB power, the Arcana Strum will automatically turn off after 5 minutes of inactivity to conserve battery power. To disable this feature, hold down the Septa-chord button until all buttons light up.

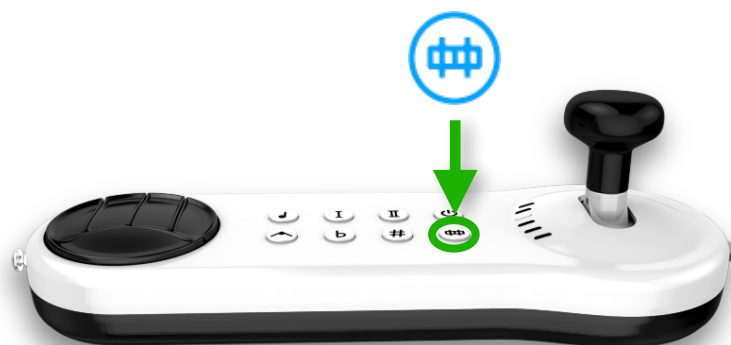

Disable Function Buttons and Lights

If you wish to avoid accidental pressed of buttons or reduce distraction of function button lights, hold down the Sustain button until all button lights turn off. Strum LEDs will still be working. To re-enable buttons and lights, restart the Arcana Strum.



For more support information go to <https://www.arcanainstruments.com/support>